

BASE

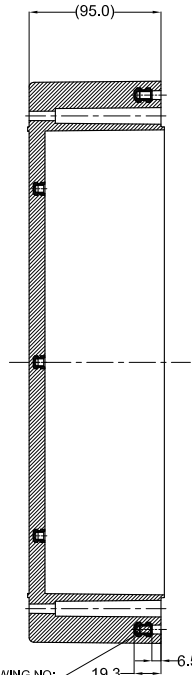

SECTION A-A

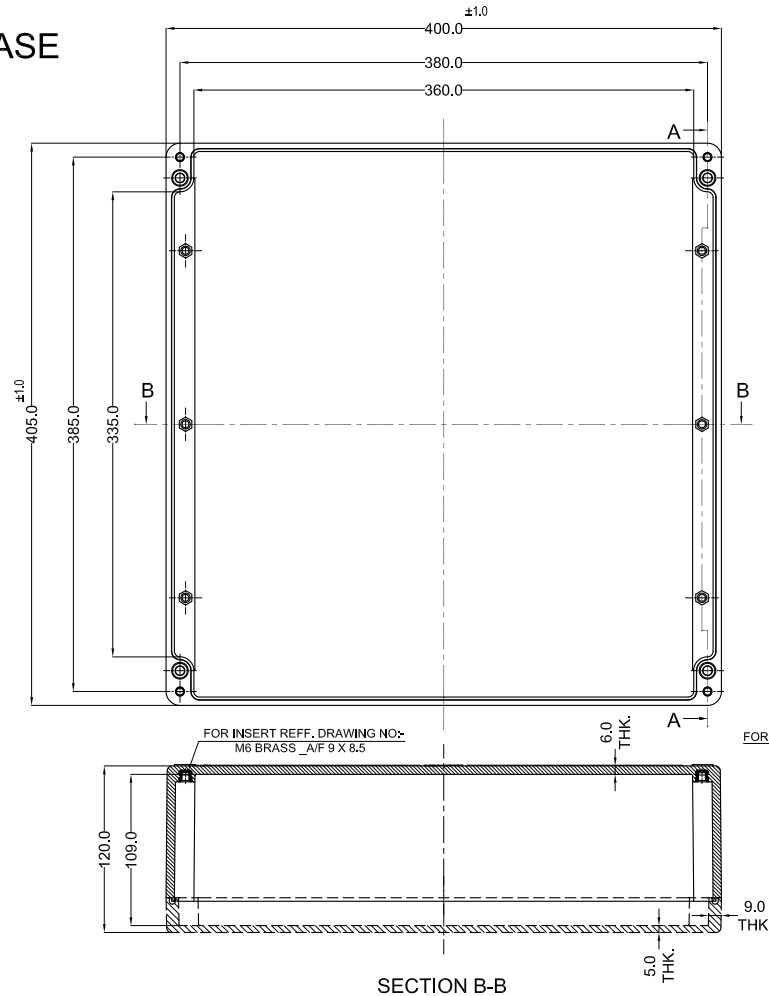
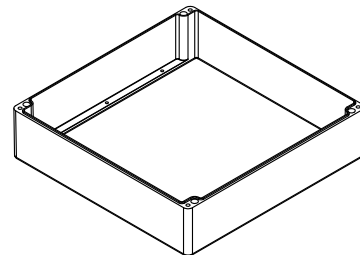

Opening Detail (Size)	Equivalent through hole dia for Gland with Earthing Plate mm	NO OF HOLES SIDE A/B	Min. Distance between the opening for Side A/B (mm)	Min. Distance between the opening for Side C/D (mm)	Opening Detail (Size) PG	Equivalent through hole dia for Gland with Earthing Plate mm	NO OF HOLES SIDE A/B	Min. Distance between the opening for Side A/B (mm)	Min. Distance between the opening for Side C/D (mm)	Opening Detail (Size) NPT	NO OF HOLES SIDE A/B	Min. Distance between the opening for Side A/B (mm)	Min. Distance between the opening for Side C/D (mm)	Min. Distance of last opening from the enclosure end on side A/B (mm)	Min. Distance of last opening from the enclosure end on side C/D (mm)		
M12	12	42	8	36	Fig.7	12.5	40	8.5	36	8.5	1/4" NPT	42	10	36	10	28	39
M16	16	30	8	30	Fig.9	15.2	30	9	28	9	3/8" NPT	30	10	30	10	29	39.5
M20	20	20	8	18	Fig.11	18.6	24	8.5	20	8.5	1/2" NPT	20	10	18	10	28	39
M25	25	16	12	14	Fig.22.5	20.4	18	8.5	16	8.5	3/4" NPT	16	14	14	14	31	41
M32	32	10	16	8	Fig.16	22.5	12	10	10	10	1" NPT	10	18	8	18	36	43
M40	40	5	20	5	Fig.21	28.3	10	13	8	13	1-1/4" NPT	5	22	5	22	40	45
M50	50	4	21	4	Fig.26	37	7	17	6	17	1-1/2" NPT	4	21	4	21	31	35.5
M63	63	3	24	3	Fig.36	47	5	20	4	20	2" NPT	3	20	3	20	41	45.5
					Fig.42	54	3	21	3	21						38	44
					Fig.48	59.3											

NOTE :-

- 1) MACHINING DIMENSIONS TOLERANCE - ISO 2768-m
- 2) ALL EDGES ARE BURR FREE
- 3) HOLE AND THREADED HOLES PERPENDICULAR TO THE BOX FACE

PROPERTY OF RaychemRPG (P) LTD.
ALL RIGHTS RESERVED AND/OR PHOTOCOPIING THIS DOCUMENT TO A PERSON WITHOUT RaychemRPG (P) LTD. WRITTEN AUTHORIZATION IS PROHIBITED

3	GASKET	-	SILICONE
2	GJB-405400120-B-02	SMC-808-30	BLACK RAL9011
1	GJB-405400120-B-01	SMC-405-23	GREY RAL7000
Sr.No.	Drawing no.	RM Grade	Finish

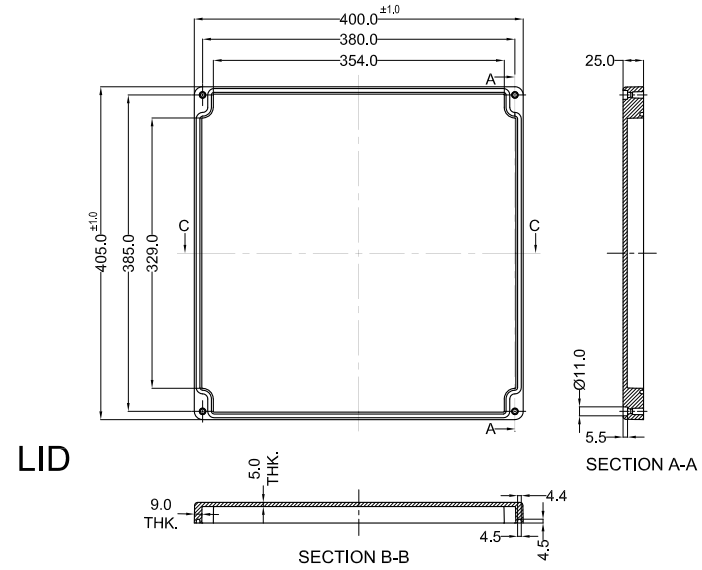

LID

GENERAL SPECIFICATION AND AREA CLASSIFICATION:

1. STANDARDS - IEC/EN 60079-0, IEC/EN 60079-7 & IEC/EN 60079-31.
2. MATERIAL - GRP - GLASS REINFORCE POLYESTER - SHEET MOLDING COMPOUND
3. DEGREE OF PROTECTION IP66 AS PER IEC 60529 : 1989 +A1 : 2000
4. GASKET MANUFACTURER - WACKER CHEMIE AG, MODEL : CENUSIL R 150 AND - CONTINUOUS OPERATING TEMPERATURE AS - 70°C TO 200°C
5. GLASS % - 30% FOR Ex HOUSING ; DENSITY - 1.7 to 1.9 g/cm² ; IMPACT - 7J
6. SERVICE TEMPERATURE RANGE : - 50 °C to +100 °C
7. ALL DIMENSIONS ARE IN mm. UNLESS STATED OTHERWISE.
8. STANDARD COLOUR - BLACK
9. THE JUNCTION BOX WILL BE MARKED WITH

II 2 G Ex e IIC Gb
 II 2 D Ex tb IIC Db IP 66 IP
0539 DEMKO 13 ATEX XXXXXXXX
 IECEx UL 13.XXXXXU

10. TIGHTENING TORQUE - (1-2) NM
11. EXTERNAL / INTERNAL EARTHING CONDUCTOR CROSS SECTION 4mm² To 35 mm²

NO.	REV.NO.	DESCRIPTION	DATE	DRAWN	CHECKED
QUANTITY	MATERIAL :-	MACH.NAME	DATE	SIGN	NAME
-	-	-	31/03/15		RRPL DESIGN
		TITLE :- Ex TYPE	31/03/15		RAJESH DRAWN
		GRP JUNCTION BOX	31/03/15		G.K. CHECKED
		405 x 400 x 120			J.B. APPROVED
TOLERANCE	WEIGHT: FINISH:	Raychem RPG (P) Limited	SCALE	PARTNO.	ExGRJ 16
±0.2 DIMENSIONS	-	Ceat Mahal Annexe,			DRG. NO.
±0.2 HOLES	ALL DIMENSION ARE IN MM	Dr. Annie Besant Road ,			REV
ANGLES	GRJ 16	Worli , Mumbai 400030			00
		Web : www.raychemrpg.com			Ex-GRJ 16 -405400120-U