

SECTION A-A

GENERAL SPECIFICATION AND AREA CLASSIFICATION:	
1. STANDARDS	- IEC/EN 60079-0, IEC/EN 60079-7 & IEC/En 60079-31.
2. MATERIAL COMPOSITION	- AISI 12
3. DEGREE OF PROTECTION	IP66 AS PER IEC 60529 : 1989 +A1 : 2000
4. GASKET MANUFACTURER	- WACKER CHEMIE AG, MODEL: CENUSIL R 150 AND - CONTINOUS OPERATING TEMPERATURE AS - 70°C TO 200°C
5. MAGNESIUM, TITANIUM AND ZIRCONIUM CONTENTS	ARE < 2%.
6. SERVICE TEMPERATURE RANGE	: - 50 °C to +135 °C
7. ALL DIMENSIONS	ARE IN mm. UNLESS STATED OTHERWISE.
8. SURFACE	WILL PLAIN FINISH OR POWDER COATED.
9. THE JUNCTION BOX	WILL BE MARKED WITH
II 2 G Ex e IIC Gb II 2 D Ex tb IIC Db IP 66 0539 DEMKO 13 ATEX 1327771U IECEx UL 13.0042U	
10. TRADE MARK	
11. TIGHTENING TORQUE	-(2-3) NM
NOT TO BE REVISED WITHOUT NOTIFICATION TO THE ExCB/NOTIFIED BODY	

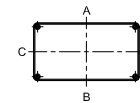

Opening Detail (Size)	NO OF HOLES SIDE A/B	Min. Distance between the opening for Side A/B (mm)	NO OF HOLES SIDE C/D	Min. Distance between the opening for Side C/D (mm)	Opening Detail (Size) PG	NO OF HOLES SIDE A/B	Min. Distance between the opening for Side A/B (mm)	NO OF HOLES SIDE C/D	Min. Distance between the opening for Side C/D (mm)	Min. Distance of last opening from the enclosure end on side A/B (mm)	Min. Distance of last opening from the enclosure end on side C/D (mm)
M12	10	14	4	12	Pg.7	10	14	4	12	15	26
M16	10	14	4	12	Pg.9	10	14	4	12	15	26
M20	9	9	3	10	Pg.11	10	8	4	8	15	24
M25	3	20	1	-	Pg.13.5	9	9	3	9	17	28
M32	3	18	1	-	Pg.16	7	10	2	10	14	30
M40	-	-	-	-	Pg.21	3	19	1	-	18	28
M50	-	-	-	-	Pg.29	2	38	1	-	23	29
M63	-	-	-	-	Pg.36	-	-	-	-	-	-
-	-	-	-	-	Pg.42	-	-	-	-	-	-
-	-	-	-	-	Pg.48	-	-	-	-	-	-

NO.	REV.NO.	DESCRIPTION	DATE	DRAWN	CHECKED
QUANTITY	MATERIAL :-	MACH.NAME	DATE	SIGN	NAME
	AISI12		17/02/14		RRPL DESIGN
	DIN230		17/02/14		ABHAY DRAWN
		TITLE :-	17/02/14		G.K. CHECKED
		JUNCTION BOX	17/02/14		J.B. APPROVED
		160 x 100 x 81			
TOLERANCE	WEIGHT	FINISH	SCALE	PARTNO.	DRG. NO.
±0.1 DIMENSIONS ±0.1 HOLES ±1.0° ANGLES	-	NATURAL	1:1		Ex-AJB-16010081

SR.NO.	PART NAME	DRAWING NO.	MATERIAL	QTY
5	SILICON GASKATE	-	SILICON	1
4	JB-EARTHING M4 SCREW	-	AISI 304/AISI 316	4
3	JB-M4 SCREW	-	MS/304/316/COPPER	4
2	BASE JUNCTION BOX 160 X160X91	Ex-R-16010081-B	AISI 12	1
1	LID JUNCTION BOX 160 X160X91	Ex-R-16010081-L	AISI 12	1

PROPERTY OF RaychemRPG (P) LTD.
ALL RIGHTS RESERVED AND/OR PHOTOCOPIING THIS DOCUMENT
TO A PERSON WITHOUT RaychemRPG (P)LTD. WRITTEN AUTHORIZATION IS PROHIBITED

Raychem RPG (P) Limited
Cesal Mahal Annex, Dr. Annie Besant Road, Worli, Mumbai 400030
Web: www.raychemrpg.com